

Cedar

Shed & Garden Kits

6'X3' Garden in a Box Greenhouse Kit Assembly Manual

Made with North American Western Red Cedar

www.CedarShedAndGardenKits.com

info@CedarShedAndGardenKits.com

Free Delivery from the Factory to
your Home, Ranch or Business.

Thanks for your interest in the 6x3
Garden in a Box, John and Pat

Please take the time to identify all
the parts prior to assembly.

Please use Safety Eyewear and Gloves
while assembling. Be sure to read and
follow all operating instructions for any
tools used during assembly.

Remember- NO SAW CUTTING IS
REQUIRED!

Safety Points and Other Considerations

Please follow this instruction manual when
assembling your Raised Garden Bed
Greenhouse Kit and retain the manual for
future maintenance purposes.



**Estimated Assembly Time for the
Greenhouse Kit = 3/4 Hour.**

Greenhouse pieces have sharp edges that can cut. Please use the safety equipment below:

Safety Equipment Required (Not Provided)



Safety Glasses



Work Gloves

In the event of missing or broken pieces, please call the Customer Support Line within 30 days of the delivery of your kit. You'll find the number in your Assembly Manual that comes with the kit. It is our commitment to you to deliver replacement parts, free of charge, within 10 business days of your notification. Replacement parts will not be provided free of charge after the 30 day grace period.

*Cedar Shed and Garden Kits LLC is an Authorized Dealer of OLT Manufacturing
OLT reserves complete title and full intellectual property and copyright rights in any and all content within*

Exploded View and Parts List for 6x3 Raised Bed Greenhouse Kit.

Parts List

Part A 34 - Greenhouse Clips with screws. (32 required / 2 extra).

Part B 6 - Side Greenhouse Panels 34 1/2" wide x 11 1/2" high

Part C 2 - Top Greenhouse Panels 34 1/2" wide x 36" deep

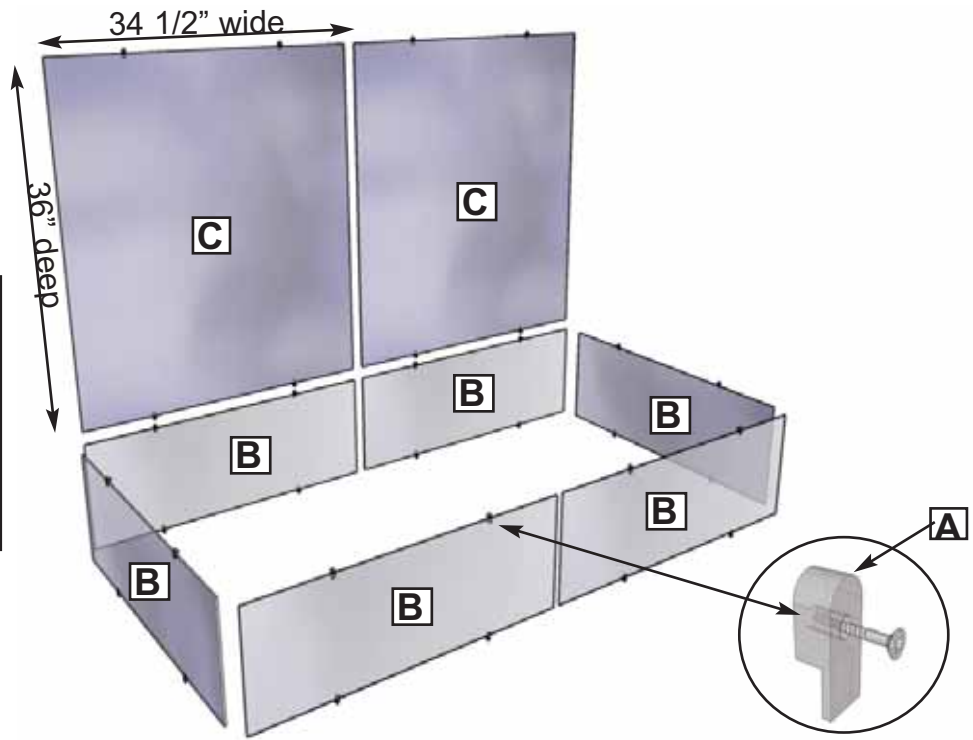

Hardware Kit (Provided)



#1 Square Drive Bit x 1 pc

Tools Required (Not Provided)



Screw Gun/Drill



1/16" Drill Bit



Screwdriver
#1 Square Drive



Tape Measure

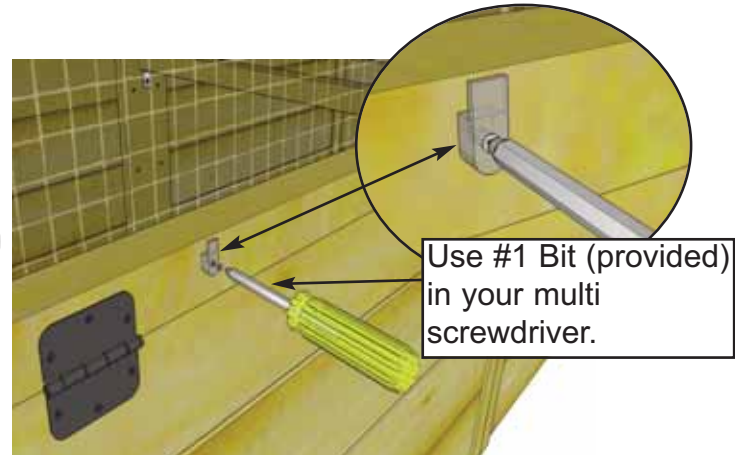
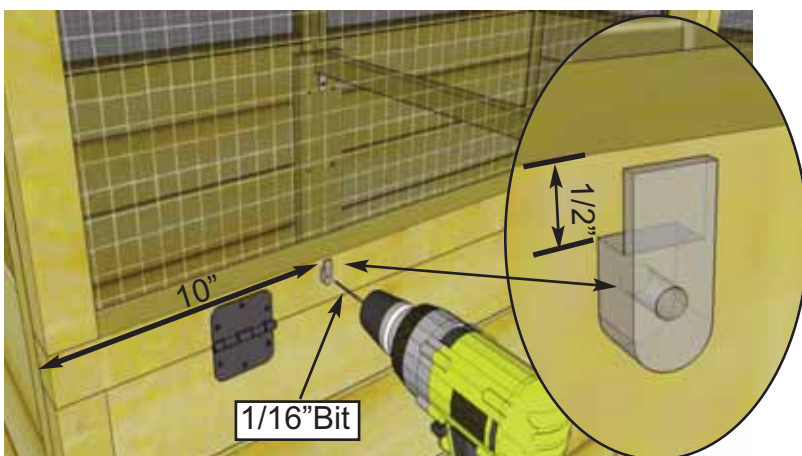

1. Start by installing bottom **Greenhouse Clips (A)** first. Measure 10" from the outside frame horizontally and recessed 1/2" down as illustrated above. Hold into position and make a shallow 1/16" diameter drill hole. Clip includes #1 square head screw. Fasten initially with screw gun and screw bit provided. Finish with Screwdriver. **Important** - Easy to crack clip when tightening with screw gun, finish tightening with screwdriver.

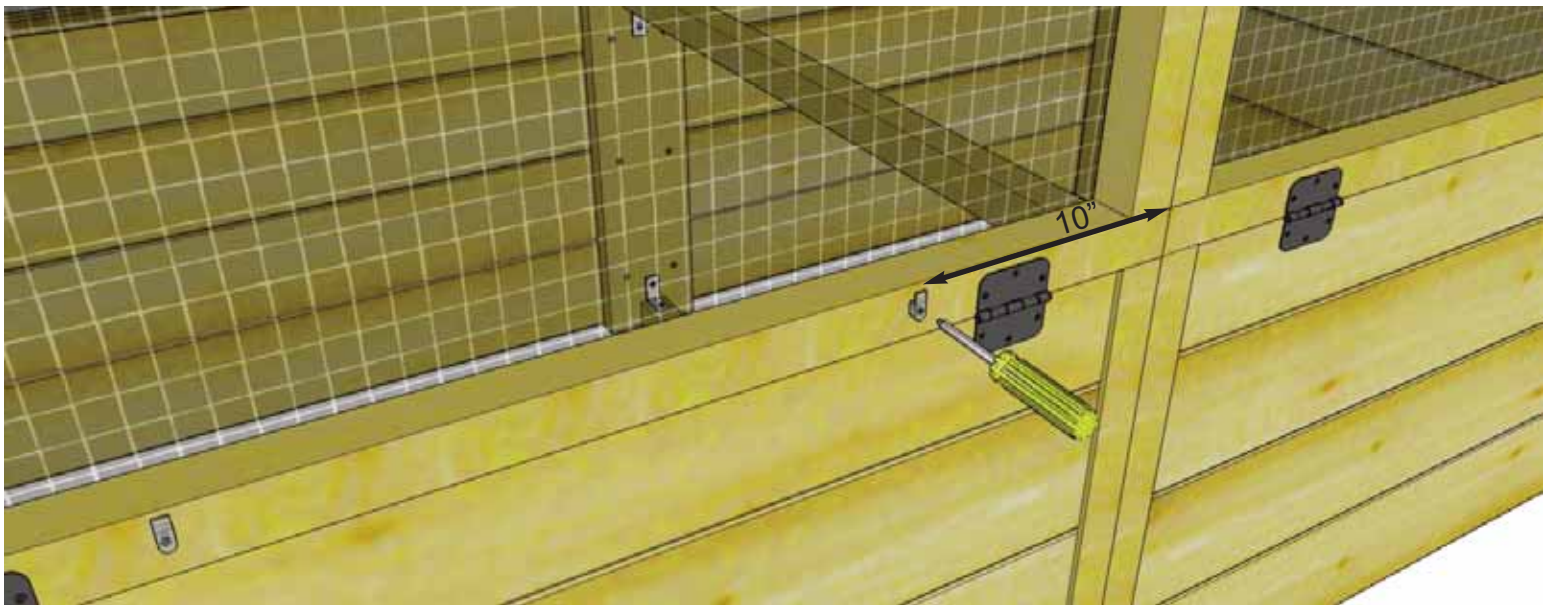

2. Complete second bottom clip as per **Step 1**.

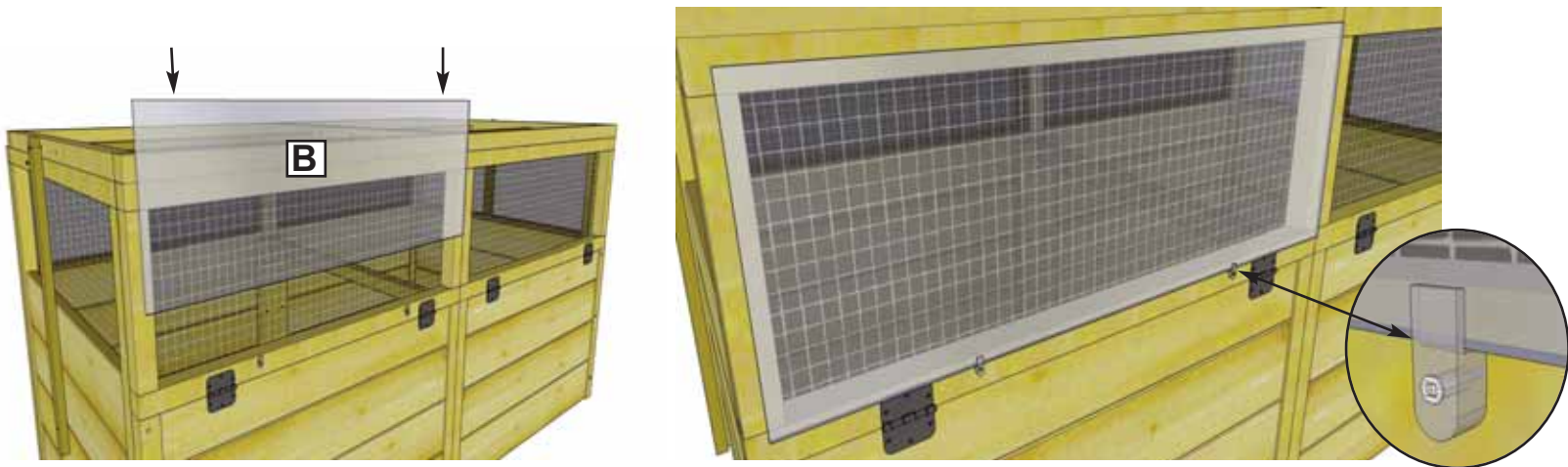

3. Locate **Side Greenhouse Panel (B)** - 34 1/2" x 11 1/2". Be sure to use safety gloves when handling panel as edges are sharp and can cut. Slip bottom of panel into clip as shown above.

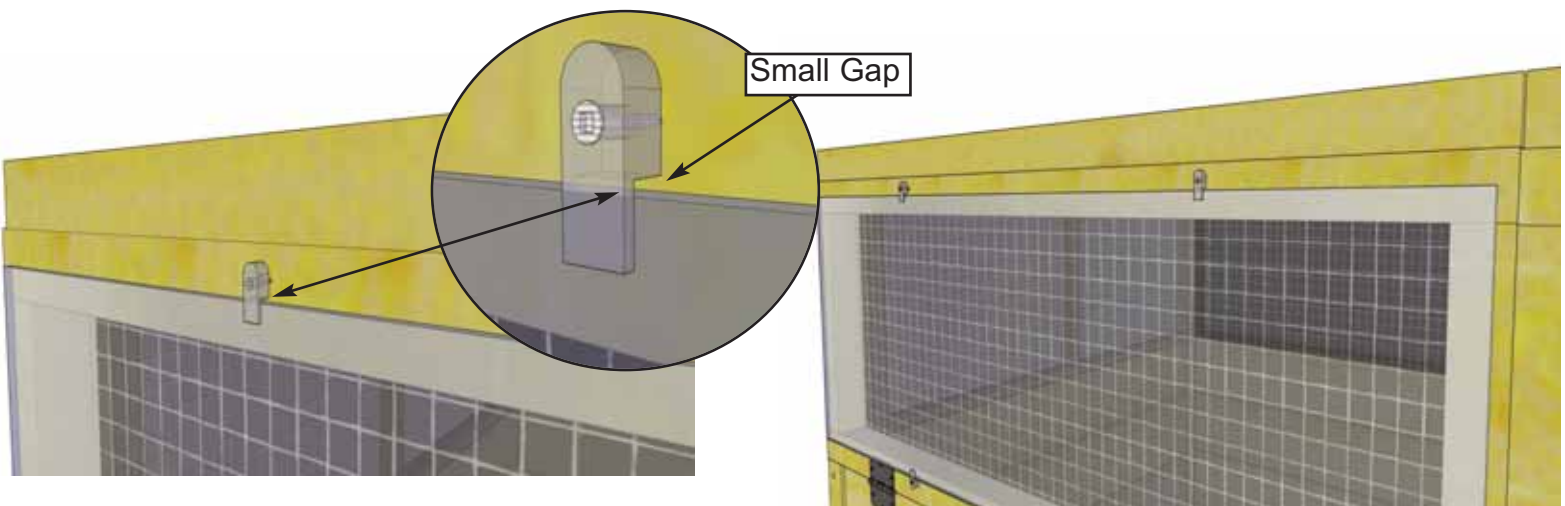

4. While holding greenhouse panel in place, attach 2 top clips as per **Step 1**. Leave a small gap between the panel and the clip. Use 4 clips per panel.

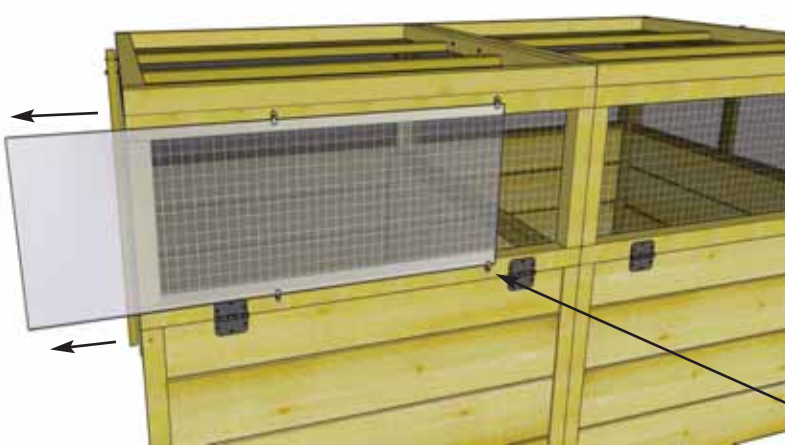

Slide up to Clip.



5. The greenhouse panel should be able to slide back and forth allowing air flow into the raised bed as required. Check and adjust clips if necessary.



6. Complete attachment of remaining front and rear greenhouse clips and panels as per **Steps 1 - 5**.

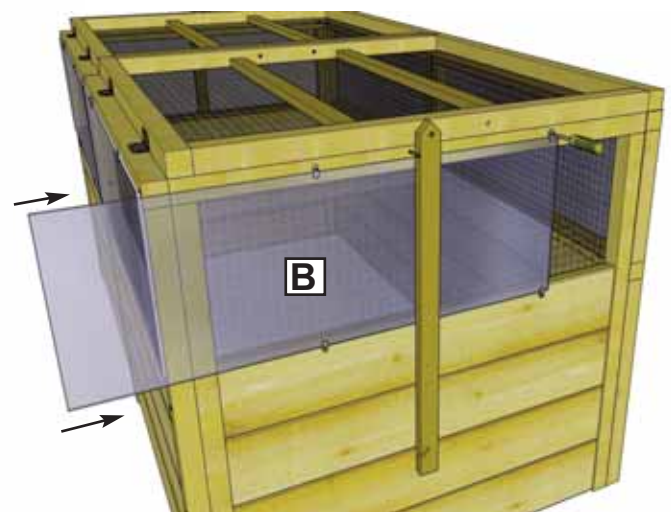
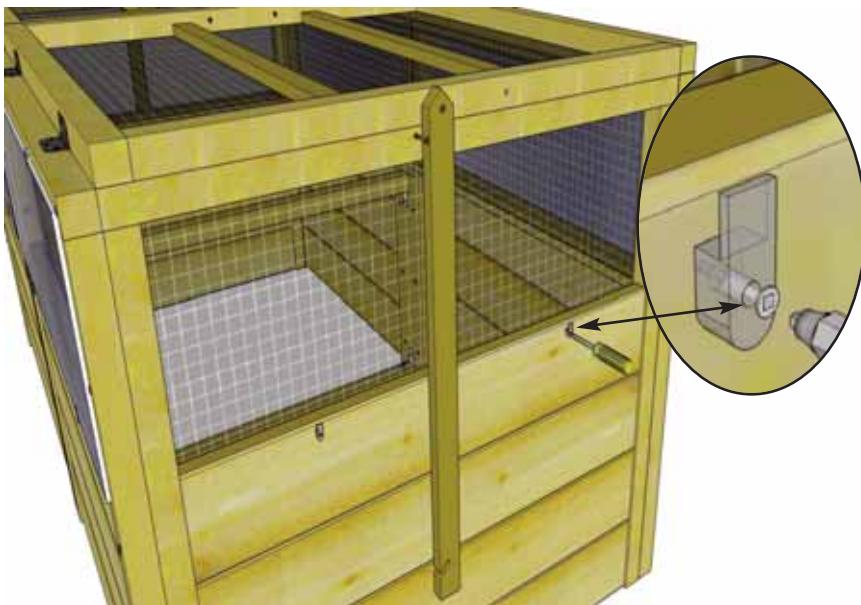

7. To complete side greenhouse panels, install clips as per **Steps 1 & 2**. Slide greenhouse panel from the side instead of from the top as the trellis/lid arm will interfere. Complete as per **Steps 3 - 5**.

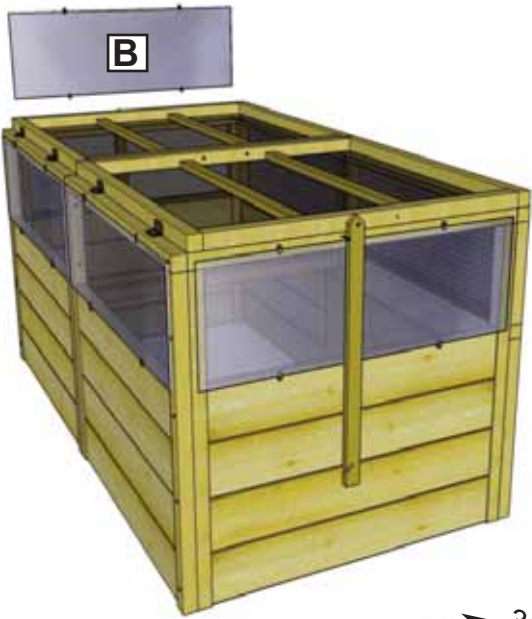

8. Install remaining side greenhouse panel as per **Step 7**.

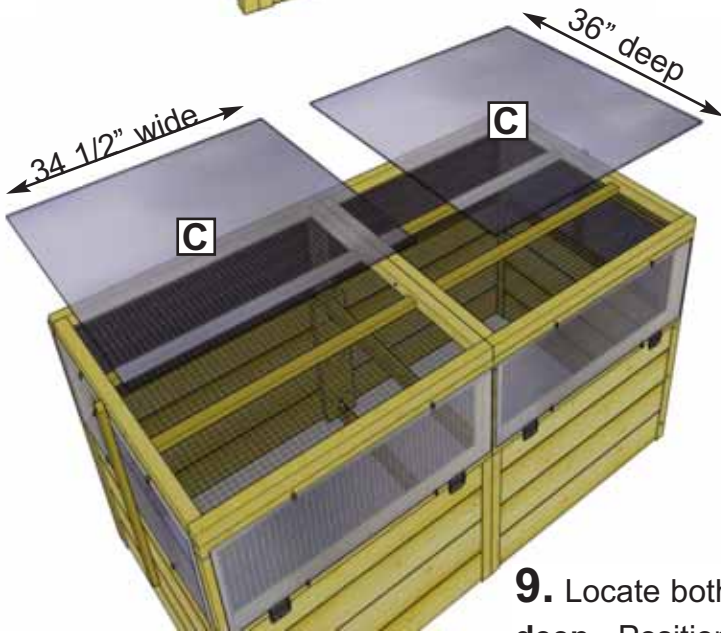

9. Locate both **Top Greenhouse Panels (C)** - 34 1/2" wide x 36" deep. Position on trellis/lid framing, evenly spacing on frame.

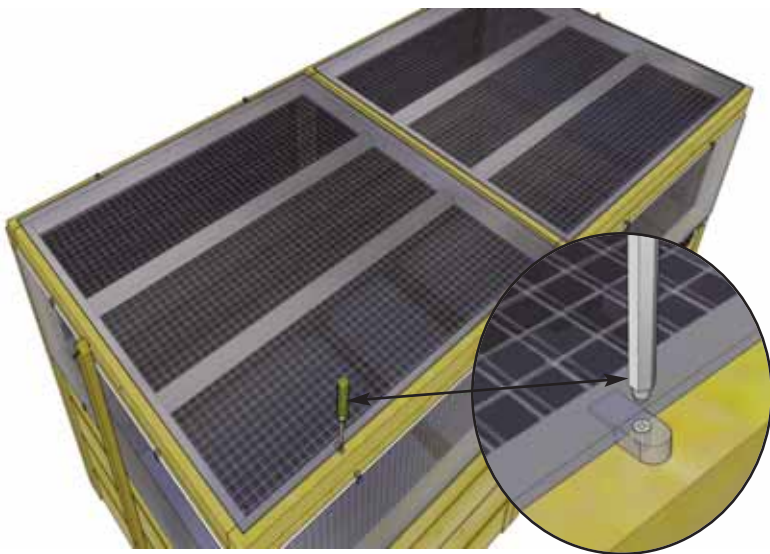

Finish with
screwdriver.



10. Secure as per **Steps 1 - 2** and **Step 4**. Complete both top panels.



Slide Open



Slide Open

11. Your 6x3 Raised Garden Bed with Greenhouse Kit is now complete. Control the temperature by simply opening or closing any of the panels. Plants like a cross breeze so open two sides as shown above.

With the addition of the Greenhouse Kit, your 6x3 Raised Garden Bed now becomes a multi-functional unit able to produce crops all year long depending on your location.



A. Fall/winter and early spring with panels on. Use as a small greenhouse.



B. Take panels off when temperatures warm up. Keep lid down to protect your young crop from pesky animals.



C. In summer, open lid up as it becomes a trellis for climbing plants.

We value your feedback and would like to hear back from you on how well we are doing in the following areas:

1. Customer Service
2. On Time Shipping
3. Motor Freight Delivery
4. Quality of Materials
5. Assembly Manual
6. Overall Satisfaction.

Please email John and Pat Motley
info@CedarShedandGardenKits.com

The materials contained in this Assembly Manual may be downloaded or copied provided that ALL copies retain the copyright and any other proprietary notices contained on the materials. No material may be modified, edited or taken out of context such that its use creates a false or misleading statement or impression as to the positions, statements or actions.